

# AB 80

YACHT OVERVIEW HULL 206



AB YACHTS

## MAIN CHARACTERISTICS:

Type of Vessel:	Motor Yacht	Gensets:	[2] KOHLER 32kW each – 240V, Single –Phase – 60hz
Shipbuilder:	AB YACHTS, Next Yacht Group		
Class & Certification:	✓ R.I.Na – C ✕ HULL ● MACH Y – Unrestricted Navigation (Pleasure Yacht) ✓ CE – Certificate – Category A	Air Conditioning:	FRIGOMAR 140.000 BTU
Dimensions:	Length Overall (LOA) 25.40 m Hull Length (LH) 23.97 m Maximum Beam 6.50 m Draught 1.35 m	Bow thruster:	Electric thruster, SIDE POWER 240V
		Voltage:	240V bi-phase, 60 Hz (USA)
		Maximum Speed:	54 knots
		Cruising Speed:	49 knots
Approx Displacement (Full):	80 Tonnes	Fuel Capacity:	9.000 litres ca.
Propulsion & Main Engines:	[3] MAN- V12-2000 Hp (1471Kw-2300RPM) [2] MJP steerable waterjets + [1] MJP central booster	Water Capacity:	2.000 litres

# ACCOMMODATIONS:

## **Owner's Cabin and Guests:**

- [1] Suite Owner (full beam) on the Lower deck
- [1] Vip Cabins on the Lower deck
- [2] Guest Cabins with two bed each on the Lower Deck

## **Crew:**

- [1] Crew Cabin with two beds

## **Bathrooms:**

- [4] Guests bathroom
- [1] Day-head on the Main Deck
- [1] Crew Bathroom































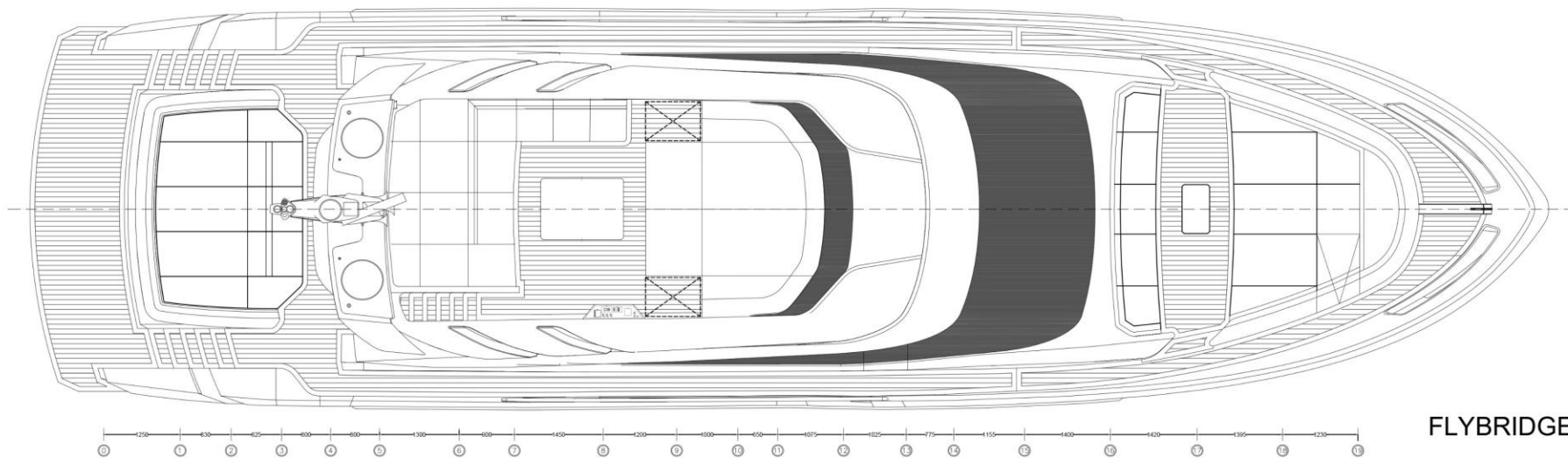
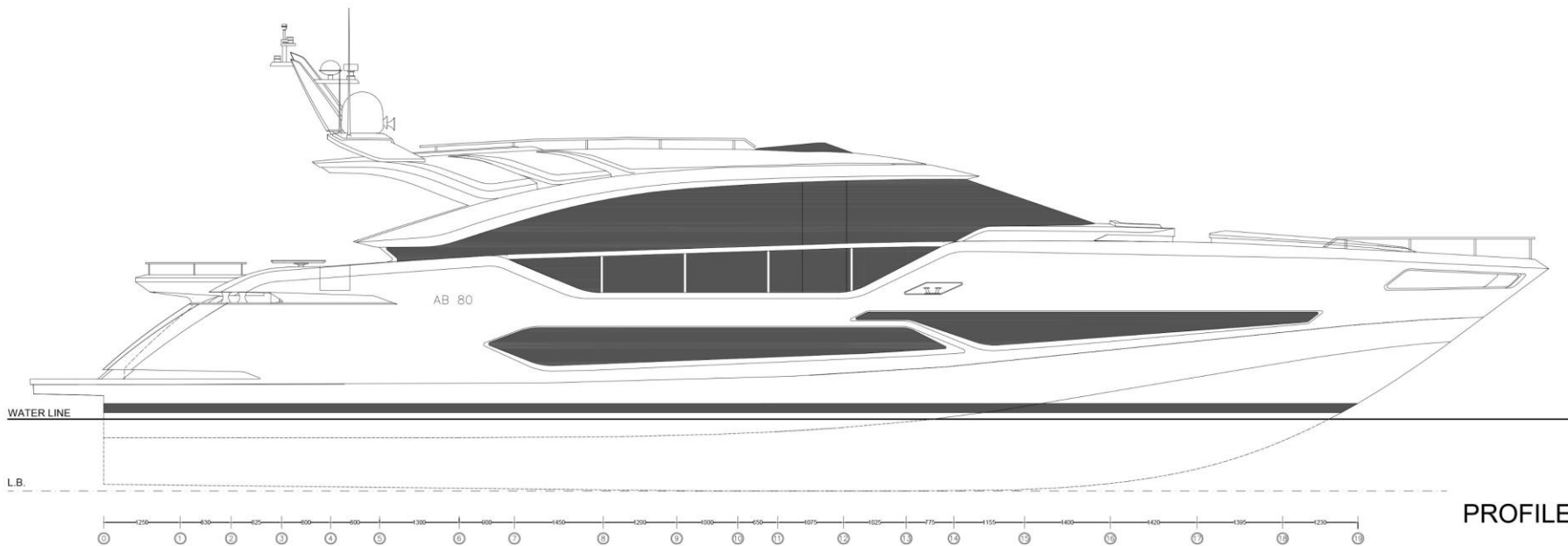



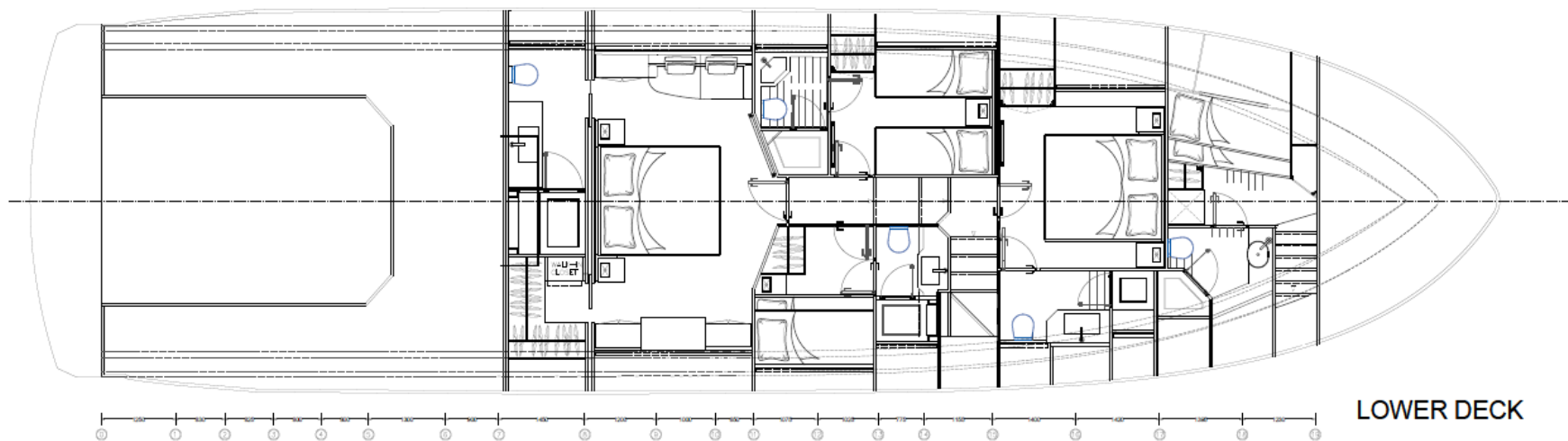
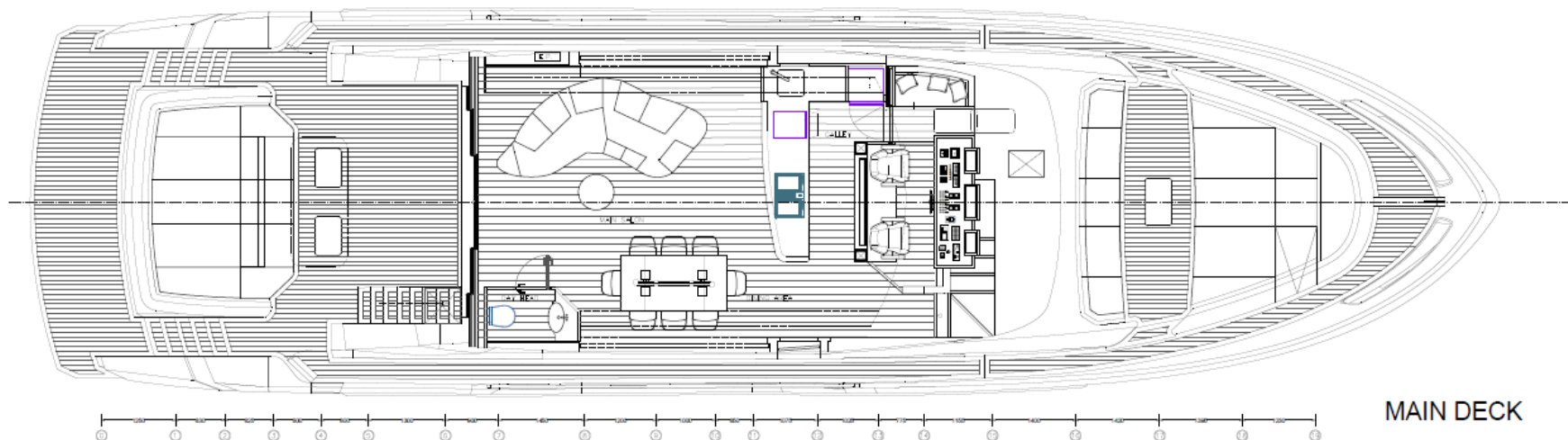

## HOUSEHOLD APPLIANCES:

### Galley:

- [1] BORA Extraction hood
- [1] BORA Cooking top (composed by: n.1 Induction top 32cm, n.1 Teppan Yaki)
- [1] MIELE Oven 60 cm
- [1] MIELE Dishwasher 45 cm
- [1] Sink 40x40 cm
- [1] LIEBHERR Fridge/Freezer in column height 177 cm

### Crew:

- [1] MIELE Washer/ Dryer GE Appliances

*[Modifications/additions to the following configuration are given in Annex D]*

# ELECTRONIC NAVIGATION EQUIPMENT:

## **On the Wheelhouse:**

- [1] SIMRAD monitor 24" + [2] monitors 19" (on one of the 19" Monitors it will be visible the Monitoring System)
- SIMRAD Radar Halo 24
- SIMRAD Echosounder (graphic)
- AIRMAR transducer (log,speed,temp) data only
- SIMRAD Autopilot
- SIMRAD VHF
- [2] SIMRAD GPS
- SIMRAD AIS [optional]
- AIRMAR Weather Station [optional]

## **Fly bridge:**

Mini-station on Sundeck: [optional]

- VHF SIMRAD remote handset [optional]
- Multifunctional colour display 4.1" mod.IS42 (for data only) [optional]

*[Modifications/Integrations to the above configuration of Navigation Equipment are reported in Annex D]*



# AUDIO-VIDEO SYSTEM:

## Owner's Cabin:

- [1] SAMSUNG Smart TV Led 43"
- [1] HDMI&USB - Wall Plate
- Streaming: Netflix e Disney+ via Smart TV. Spotify via Bluesound amplifier
- [2] Dynaudio P4-W65 speaker 6,5" rectangular
- [1] APPLE iPad mini 6 64GB Wi-Fi (Crestron configured)
- TV Receiver/ Decoder (Owner's supply)

## Guest Cabins (x2) Equipment list per Cabin:

- [1] SAMSUNG Smart TV 32" Full HD for the Guest Cabin Port side
- [1] SAMSUNG Smart TV 24" Full HD for the Guest Cabin Starboard side
- [1] HDMI&USB - Wall Plate
- Streaming: Netflix e Disney+ via Smart TV. Spotify via Bluesound amplifier
- [2] Dynaudio P4-W65 speaker 6,5" rectangular
- [1] APPLE iPad mini 6 64GB Wi-Fi (Crestron configured)
- TV Receiver/ Decoder (Owner's supply)

## Vip Cabin:

- [1] SAMSUNG Smart TV 32" Full HD
- [1] HDMI&USB - Wall Plate
- Streaming: Netflix e Disney+ via Smart TV. Spotify via Bluesound amplifier
- [2] Dynaudio P4-W65 speaker 6,5" rectangular
- [1] APPLE iPad mini 6 64GB Wi-Fi (Crestron configured)
- TV Receiver/ Decoder (Owner's supply)

## Main Salon:

- [1] SAMSUNG Smart TV 65" 4K
- [1] HDMI&USB - Wall Plate
- Streaming: Netflix e Disney+ via Smart TV. Spotify via Bluesound amplifier
- [5] Dynaudio P4-W65 speaker 6,5" rectangular
- [1] JL-Audio Home subwoofer 8
- [1] Apple iPad Mini 6 64GB Wi-Fi (Crestron configured)
- TV Receiver/ Decoder (Owner's supply)

**External Area (for Aft Deck, Bow and Fly bridge):**

- JL-Audio waterproof Speakers 770 Luxe 7.7” - 4x Aft Deck, 2x Bow, 4x Sun Deck
- [1] Amplifier, with 2 channels for each area, including Airplay 2 and Spotify Connect streaming

**Party Mode:**

Party mode option will replicate settings of Main Salon and will merge areas of: Aft Deck, Bow and Flybridge

*[Modifications/Integrations to the following Audio-Video configuration are reported in Annex D]*

## OPTIONAL LIST INCLUDED:

- Class R.I.Na. - C ⚡ HULL • MACH Y – Unrestricted Navigation (Pleasure)
- Seamless Transfer: “No-Power-blackouts” smart technology in order to avoid the blackouts from switching the genset power onto the shore power supply, and vice versa
- Gyroscopic stabilizers Seakeeper mod.18: working at anchor (“zero speed”) and in navigation (“underway”)
- AIS + Weather Station
- Genset’s Parallel system
- Monitoring System
- Monitoring system redundancy, in Crew Area
- Aft Third Control Station
- Stern garage and haulage/launching system for tender/jet ski
- N.4 underwater lights on the transom, white colour
- Watermaker IDROMAR 180 Lt/hr instead of 130 Lt/hr
- Electric blind curtains in the Salon
- Electric blind curtains in the Lower Deck’s accommodations (Owner- Vip – Guest’s Cabin)
- Electric black-out rollers in the Master Cabin and in the Lower Deck’s accommodations (Owner- Vip – Guest’s Cabin)
- Portholes sensors
- Outdoor Awnings on aft and bow complete with Carbon fibre poles and micro-perforated technical fabric tent
- Air Conditioning Tropicalized 140.000 Btu/h, instead of standard 100.000 Btu/h
- Predisposition only for night vision camera
- Day-head in the Salon
- Mini Pilot station on the Sundeck
- Stainless steel Rub-Rail
- Frequency Converter 40 Kva
- [1] External table with up/down electric mechanism in the aft cockpit
- Dark or Metallic paint
- Teak on Sun Deck
- Plug-in carbonfibre shower in the Beach Area
- Additional Boiler 45 lt
- Air Compressor, with 3 connection points (n.1 in the aft area, n.1 in the bow area, n.1 in the E.R.)
- Glass side corridors handrail, with polished stainless steel perimetral frame



**IT and Wi-Fi:**

- [1] Peplink MAX HD1 Dome Pro 5G router with 4/5G and Wi-Fi built-in antennas
- [1] Ubiquiti Dream Machine Pro Router wireless controller, Firewall
- [1] Ubiquiti with 48 POE switch for all physical ethernet connections
- [4] Ubiquiti Access Point UniFi 6 Long-Range 4800 Mbit/s PoE (distributed across all decks)
- Cable Predisposition Only, for Starlink Maritime Antenna

**CCTV system:**

- [3] Lilin Z5R6422XR 2 Megapixel outdoor dome with IR led Camera
- [1] Lilin PZD6422EX mini PTZ (no IR) 2M pixel in Engine Room
- [1] Lilin NVR6104E 4ch PoE standalone network video recorder

*For any other possible item or customization request, the Shipbuilder will evaluate the feasibility and in case will provide a quotation*